

Three Trees Hill, Bowenfels

DA 227/22 = Proposed Subdivision – 10 Col Drewe Drive, Bowenfels NSW 2790

Additional Information: Eastern Boundary with Sweet Briar Property – Proposed fence and landscape buffer zone treatment

This document details the proposed boundary fence and landscape buffer zone on the eastern boundary of the property.

- The fence will be a 1500 mm post and rail hardwood fence with wire (for security of children and pets) as per the (see attached details and refer to the SEE and landscape plan).
- There will also be a landscape buffer zone of 2 meters that will include trees and hedge planning (see attached details and refer to the SEE and landscape plan).

CROSS SECTION OF SWEET BRIAR AND THE PROPOSED SUBDIVISION

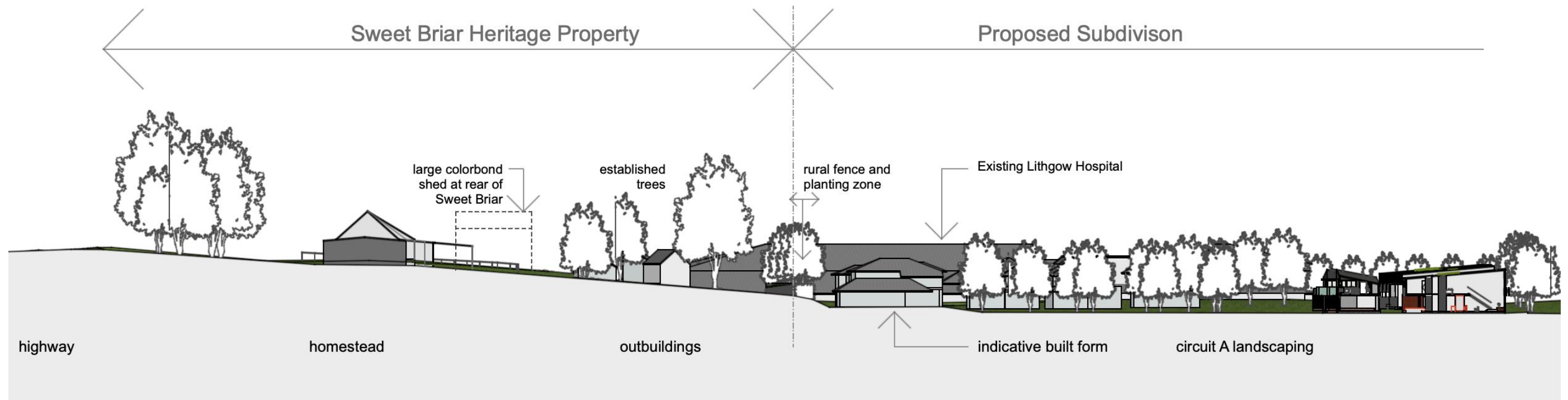

LOOKING EAST FROM THE PROPOSED SUBDIVISION TO THE SWEET BRIAR PROPERTY



LOOKING EAST FROM THE PROPOSED SUBDIVISION TO THE SWEET BRIAR PROPERTY



PROPOSED EASTERN BOUNDARY RURAL HERITAGE FENCE AND LANDSCAPE BUFFER ZONE DETAILS

(Refer to Landscaping Plans for planting details)

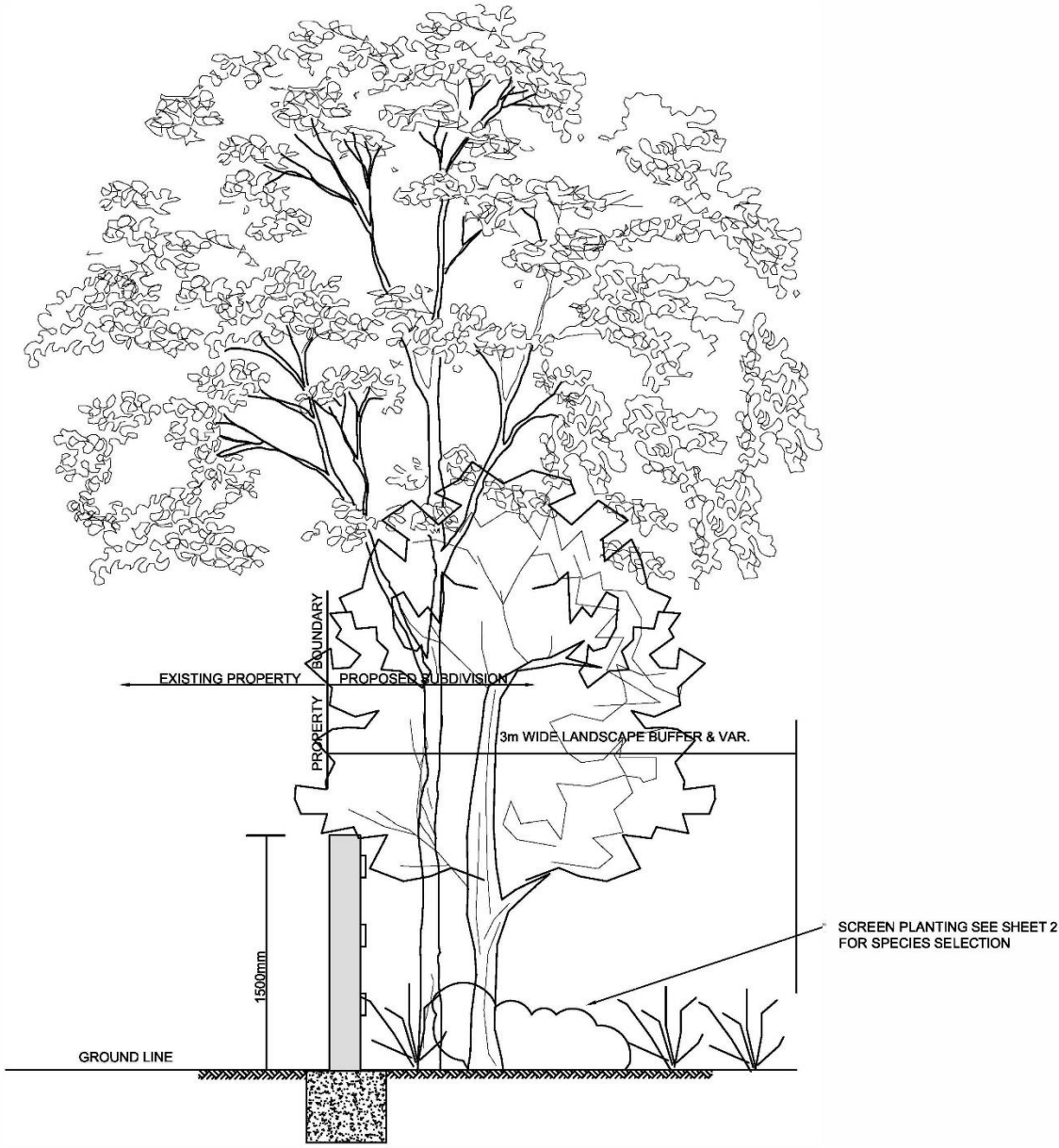

HERITAGE FENCE & PLANTED SCREEN DETAIL
1:25

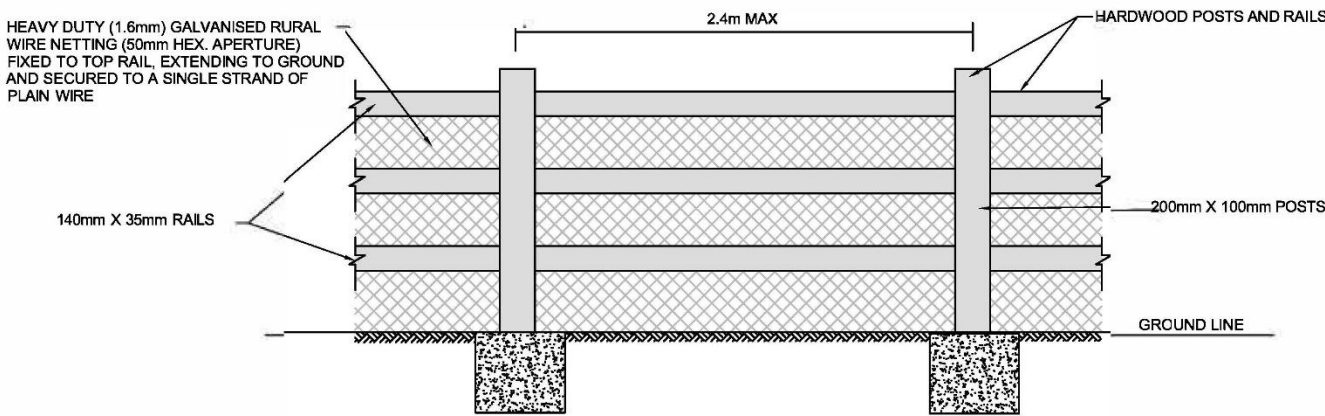

HERITAGE FENCE DETAIL
1:25